

GENERAL NOTES:

1. ALL INSTALLATIONS SHALL BE PER N.F.P.A. 13 AND ALL LOCAL CODES.
2. COORDINATE ALL NEW FIRE LINES WITH ALL MECHANICAL DUCTWORK, LIGHTS, ETC. COORDINATE ALL FIRE LINE ROUTINGS WITH ALL CEILING HEIGHT VARIATIONS.
3. INSTALL ALL VALVE CABINETS SURFACE MOUNTED ON WALLS. MOUNT BOTTOM OF CABINET 4'-0" A.F.F.
4. ALL PIPING FLOOR PENETRATIONS SHALL BE SLEEVED, COMPLETELY GROUT AROUND OUTSIDE OF SLEEVE, AND FILL SLEEVE VOID AROUND PIPE WITH FIBERFRAX FIRE-PUTTY.
5. ALL FIRE VALVE CABINETS SHALL BE CLASS I VALVE CABINETS (2 1/2" VALVE WITH CAP).
6. ALL CABINETS SHALL BE LABELED WITH ENGRAVED PHENOLIC LABELS STATING 'STANDPIPE' (3" WIDE BY 1 1/2" TALL) (RED BACKGROUND AND WHITE LETTERS).
7. ROUTE ALL HORIZONTAL PIPING AS HIGH AS POSSIBLE TO ALLOW MAXIMUM CLEARANCE FOR MECHANICAL DUCTS.
8. FIRE PROTECTION CONTRACTOR SHALL COORDINATE WITH LOCAL AUTHORITIES FOR LOCATIONS OF SIMIASEE CONNECTIONS, STORTZ CONNECTIONS, ETC.
9. CONTRACTOR TO COORDINATE LOCATIONS OF ALL REQUIRED FIRE VALVES BEFORE INSTALLATION TO ENSURE THAT THICKENED WALLS OR CHASES ARE PROVIDED.
10. LOCATE ALL PIPING FITTINGS OUTSIDE OF PARTITIONS WHERE POSSIBLE FOR ACCESSIBILITY.

FIRE SPRINKLER ZONES	
ZONE #1	ZONE #1 (WET) APPROX. 46,929 FT ²
ZONE #2	ZONE #2 (WET) APPROX. 31,232 FT ²
ZONE #3	ZONE #3 (WET) APPROX. 46,549 FT ²
ZONE #4	ZONE #4 (WET) APPROX. 37,790 FT ²

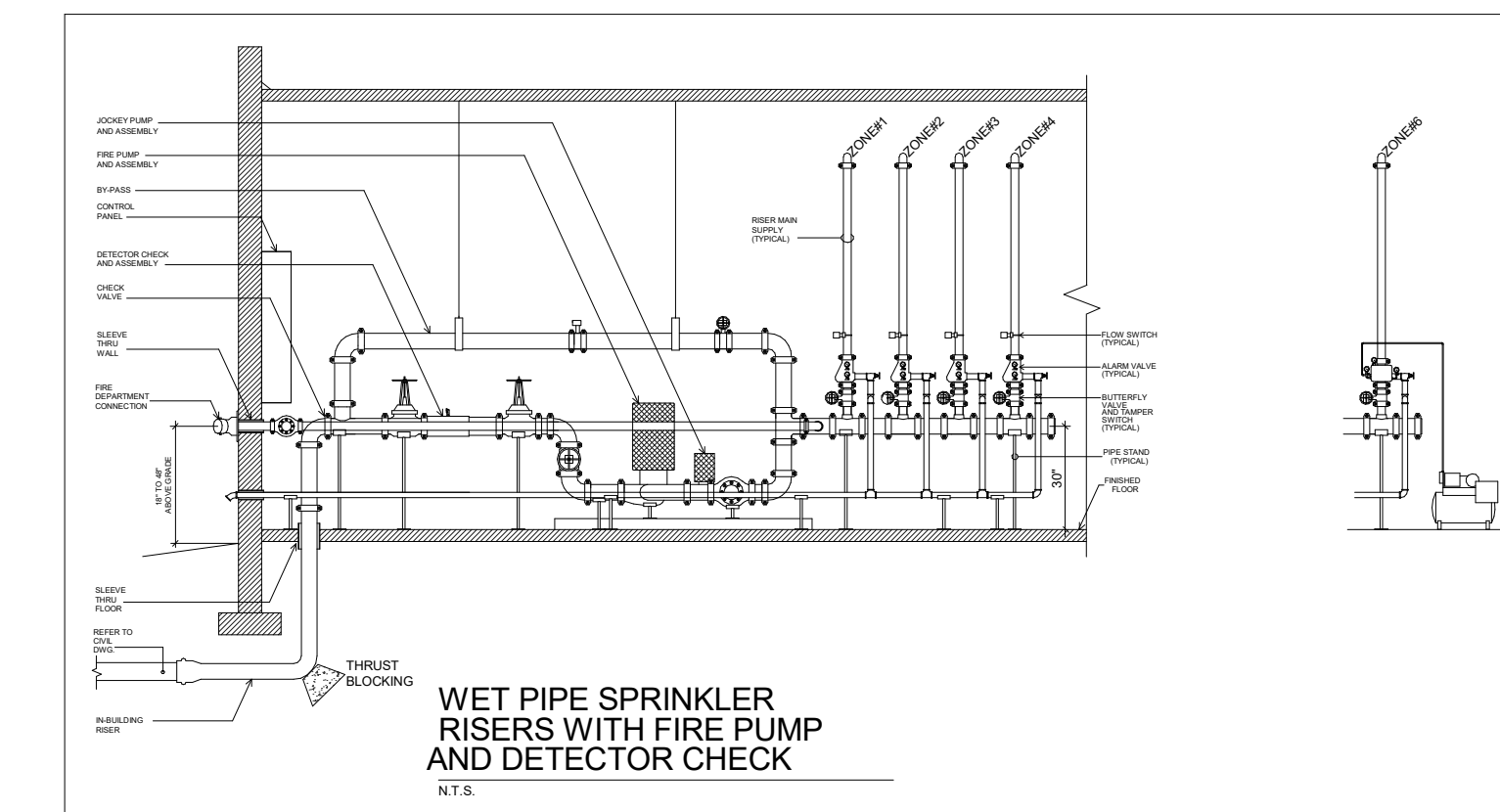

1 FIRE PROTECTION PLAN - LEVEL ONE
3/64" = 1'-0"



ISSUED: August 11, 2023

REVISIONS

Revision No. Revision Date

Director Drawn By
Approver DD
Designer Quality Control
Designer
Proj. Arch.
Checker

PROJECT NO.

22-064.00

SHEET TITLE

FIRE PROTECTION PLAN -
LEVEL ONE

SHEET NO.

FP2.11

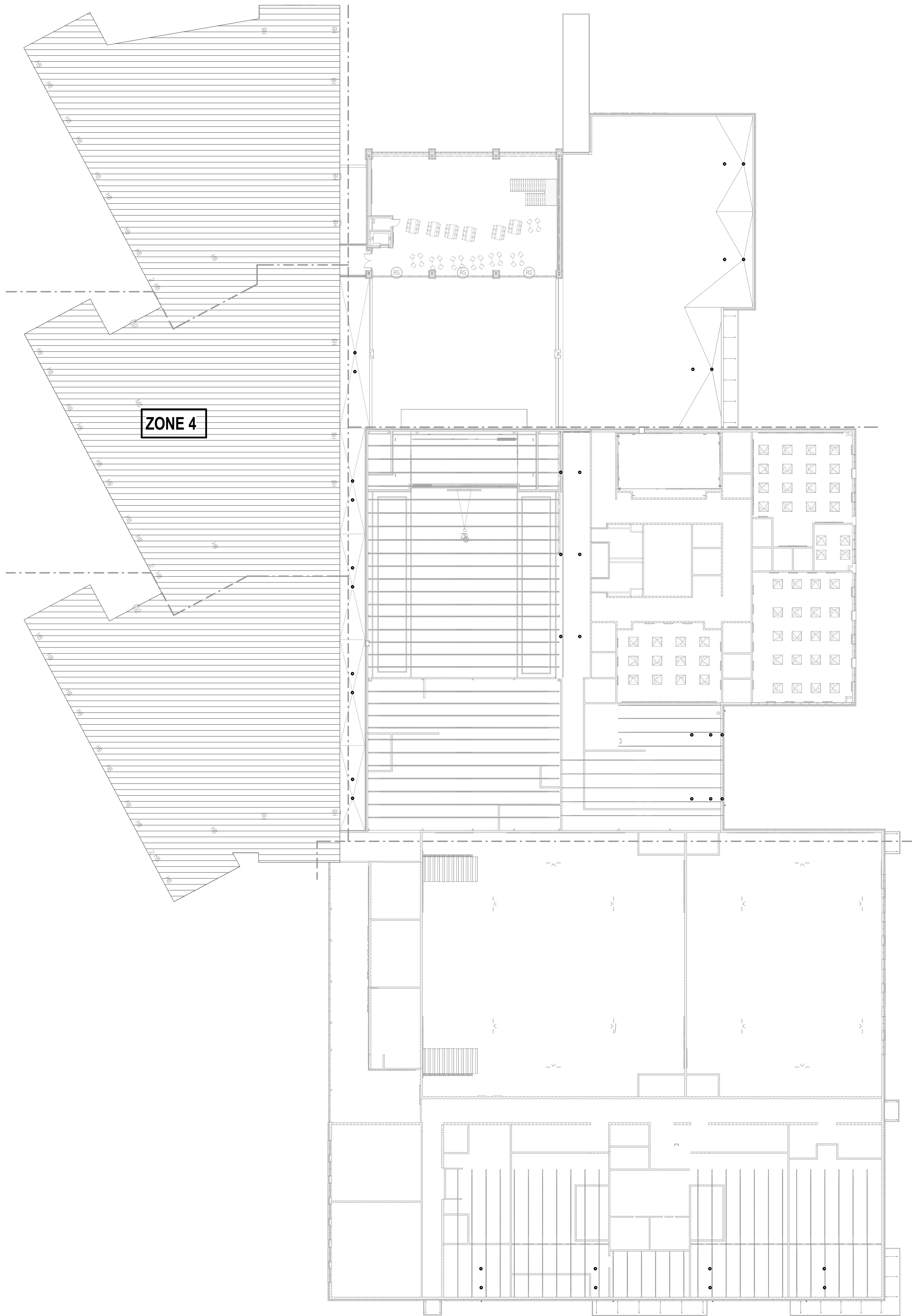

GENERAL NOTES:

1. ALL INSTALLATIONS SHALL BE PER N.F.P.A. 13 AND ALL LOCAL CODES.
2. COORDINATE ALL NEW FIRE LINES WITH ALL MECHANICAL DUCTWORK, LIGHTS, ETC. COORDINATE ALL FIRE LINE ROUTINGS WITH ALL CEILING HEIGHT VARIATIONS.
3. INSTALL ALL VALVE CABINETS SURFACE MOUNTED ON WALLS. MOUNT BOTTOM OF CABINET 4'-0" A.F.F.
4. ALL PIPING FLOOR PENETRATIONS SHALL BE SLEEVED. COMPLETELY GROUT AROUND OUTSIDE OF SLEEVE, AND FILL SLEEVE VOID AROUND PIPE WITH FIBERFRAX FIRE-PUTTY.
5. ALL FIRE VALVE CABINETS SHALL BE CLASS I VALVE CABINETS (2 1/2" VALVE WITH CAP).
6. ALL CABINETS SHALL BE LABELED WITH ENGRAVED PHENOLIC LABELS STATING 'STANDPIPE' (3" WIDE BY 1 1/2" TALL) (RED BACKGROUND AND WHITE LETTERS).
7. ROUTE ALL HORIZONTAL PIPING AS HIGH AS POSSIBLE TO ALLOW MAXIMUM CLEARANCE FOR MECHANICAL DUCTS.
8. FIRE PROTECTION CONTRACTOR SHALL COORDINATE WITH LOCAL AUTHORITIES FOR LOCATIONS OF SIMIASE CONNECTIONS, STORTZ CONNECTIONS, ETC.
9. CONTRACTOR TO COORDINATE LOCATIONS OF ALL REQUIRED FIRE VALVES BEFORE INSTALLATION TO ENSURE THAT THICKENED WALLS OR CHASES ARE PROVIDED.
10. LOCATE ALL PIPING FITTINGS OUTSIDE OF PARTITIONS WHERE POSSIBLE FOR ACCESSIBILITY.

FIRE SPRINKLER ZONES	
ZONE #1	ZONE #1 (WET) APPROX. 46,929 FT ²
ZONE #2	ZONE #2 (WET) APPROX. 31,232 FT ²
ZONE #3	ZONE #3 (WET) APPROX. 46,549 FT ²
ZONE #4	ZONE #4 (WET) APPROX. 37,790 FT ²

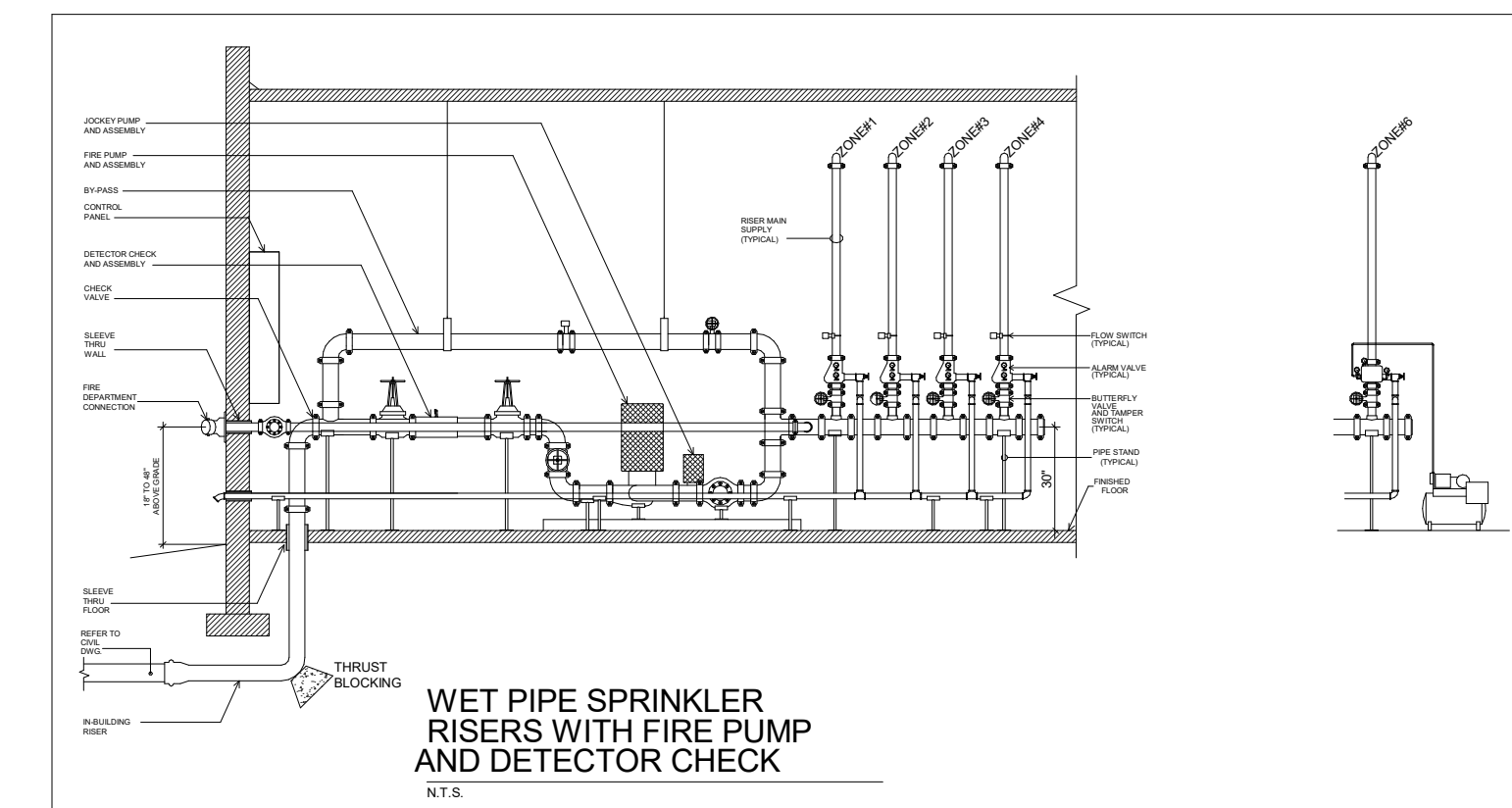

1 FIRE PROTECTION PLAN - LEVEL TWO
3/64" = 1'-0"

EMA EMA Engineering & Consulting, Inc.
 Tyler | Austin | Houston | El Paso
 DFW | San Antonio | Shreveport
 Texas Firm Registration No. F-893
 Louisiana Firm Registration No. EF-5818
 DESIGN SOLVE ENHANCE www.EMAengineer.com
 SUBMISSION OF BID WILL BE CONSIDERED ACKNOWLEDGMENT THAT THE CONTRACTOR HAS VISITED THE SITE AND HAS VERIFIED ALL EXISTING JOB CONDITIONS AND INCLUDED ANY NECESSARY MODIFICATION TO EXISTING AND NEW WORK REQUIRED FOR INSTALLATION OF A COMPLETE AND WORKING SYSTEM.



ISSUED: August 11, 2023

REVISIONS

Revision No. Revision Date

Director Drawn By
 Approver DD
 Designer Quality Control
 Designer
 Proj. Arch.
 Checker

PROJECT NO.

22-064.00

SHEET TITLE

FIRE PROTECTION PLAN -
LEVEL TWO

SHEET NO.

FP2.12